

Series 007/007DCDA

Double Check Valve/ Double Check Detector Assembly Sizes 2" - 3"

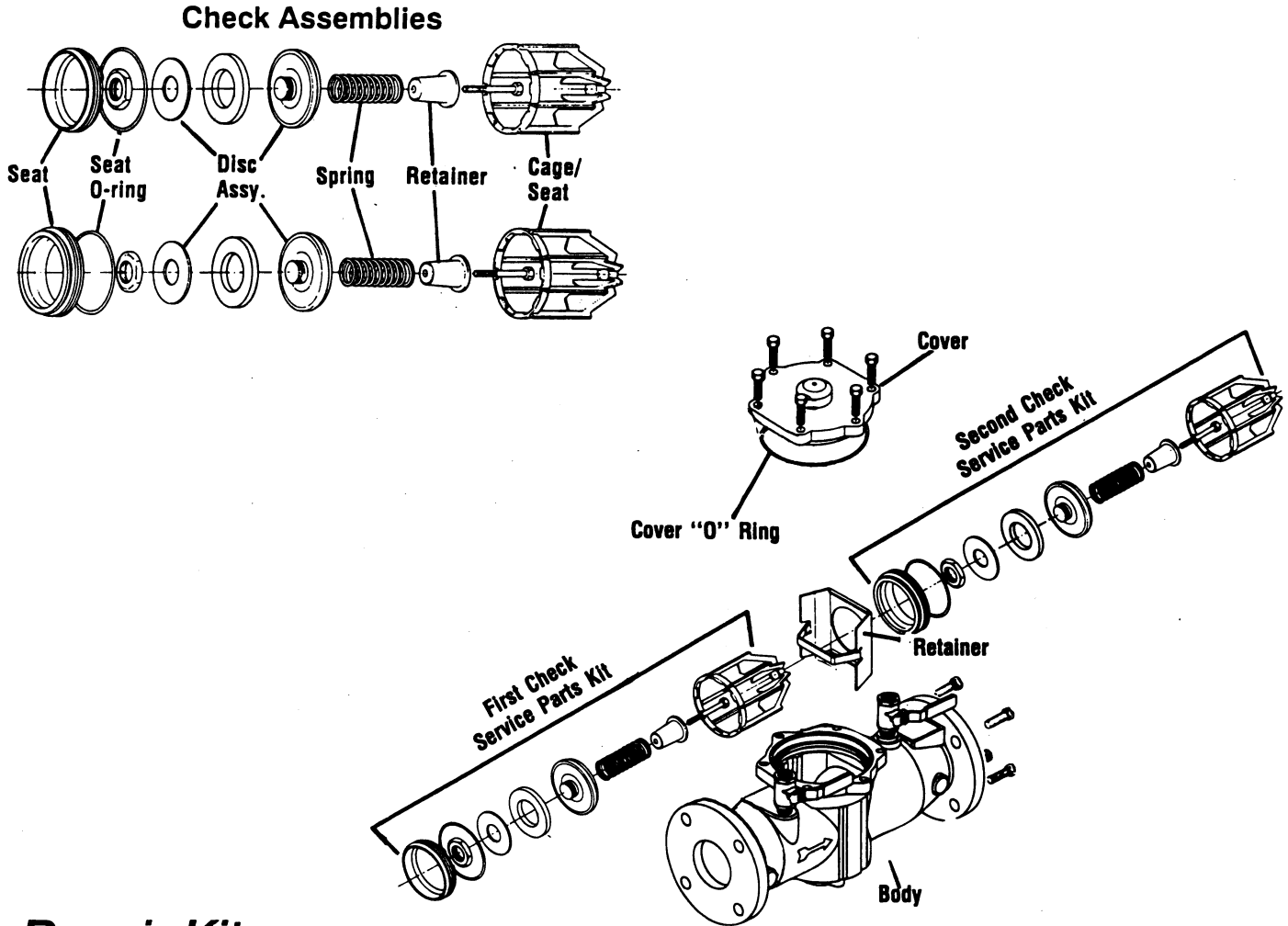

Repair Kits:

When ordering specify EDP No., Kit No., and Valve Size.

EDP No.	Kit No.	Size
---------	---------	------

First Check Kit

887980	RK 007DCDA CK1	2"
887285	RK 007 CK1	2½", 3"
887965	RK 007DCDA CK1	2½", 3"

Kit consist of: Seat, Seat o-ring, Disc assembly, Spring, Spring retainer, Check cage and Cover o-ring.

Second Check Kit

887981	RK 007DCDA CK2	2"
887286	RK 007 CK2	2½", 3"
887966	RK 007DCDA CK2	2½", 3"

Kit consist of: Seat, Seat o-ring, Disc assembly, Spring, Spring retainer, Check cage and Cover o-ring.

First and Second Check Rubber Parts

887982	RK 007DCDA RT	2"
887287	RK 007 RT	2½", 3"
887967	RK 007DCDA RT	2½", 3"

Kit consist of: Two seat discs, Two seat o-rings, and Cover o-ring.

EDP No.	Kit No.	Size
---------	---------	------

Cover Kit

887983	RK 007DCDA C	2"
887288	RK 007 C	2½", 3"
887970	RK 007DCDA C	2½", 3"

Kit consist of: Cover, cover o-ring.

Seat Kit

887984	RK 007DCDA S1	2"
887985	RK 007DCDA S2	2"
887289	RK 007 S1	2½", 3"
887290	RK 007 S2	2½", 3"
887968	RK 007DCDA S1	2½", 3"
887969	RK 007DCDA S2	2½", 3"

Kit consist: Seat, Seat o-ring and cover o-ring.