

Note: Repair kits on page FM6

Item #	Qty	Description	Material	ASTM	Item #	Qty	Description	Material	ASTM
1	1	Body	Ductile Iron*	60-40-18	21	1	RV Disc Holder	Noryl GFN2-780S	—
2	1	Cover	Ductile Iron*	60-40-18	22	1	RV Seat O'Ring	Buna-n	—
3	4	Ball Valve	Unleaded Bronze	C90500	23	1	RV Seat	Stainless Steel	304
4	1	Diaphragm	Nitrile/Nylon	—	24	1	RV Disc	Silicone Rubber	—
5	2	RV Diaphragm Plate	Stainless Steel	304	25	1	RV Disc Retainer	Noryl GFN2-780S	—
6	1	RV Bushing O'Ring	Buna-n	—	26	1	RV Spring	Stainless Steel	302
7	1	RV Cover Bushing	Unleaded Bronze	C89833	27	1	2nd CV Stem Retainer	Stainless Steel	304
8	1	RV Piston O'Ring	Silicone Rubber	—	28	1	2nd CV Spring	Stainless Steel	302
9	1	RV Piston	Noryl GFN2-780S	—	29	1	2nd CV Seat Ring	Unleaded Bronze	C89833
10	1	RV Stem O'Ring	Buna-n	—	30	3	Nipple	Red Brass	—
11	1	RV Stem	Stainless Steel	304	31	1	ID Tag	Brass	—
12	1	1st CV Stem Retainer	Stainless Steel	304	32	2	Grip Nail	Stainless Steel	304
13	1	1st CV Spring	Stainless Steel	302	33	2	R.W. NRS Gate Valve	Cast Iron*	—
14	2	CV Stem	Stainless Steel	304	34	12	Bolt	Galvanized Steel	—
15	1	1st CV Seat Ring	Unleaded Bronze	C89833	35	16	Nut	Galvanized Steel	—
16	2	CV O'Ring	Buna-n	—	36	16	Bolt	Stainless Steel	18-8
17	2	CV Disc Retainer	Stainless Steel	304	37	2	Ring Gasket	Buna-n	—
18	2	CV Disc	Silicone Rubber	—	38	1	Nipple	Red Brass	—
19	2	CV Spring Clip	Stainless Steel	302	39	1	NPT Plug	Red Brass	—
20	2	CV Disc Holder	Unleaded Bronze	C89833					

CV = Check Valve
RV = Relief Valve
* = Items are Epoxy Coated
Items 33-39 are not shown on drawing

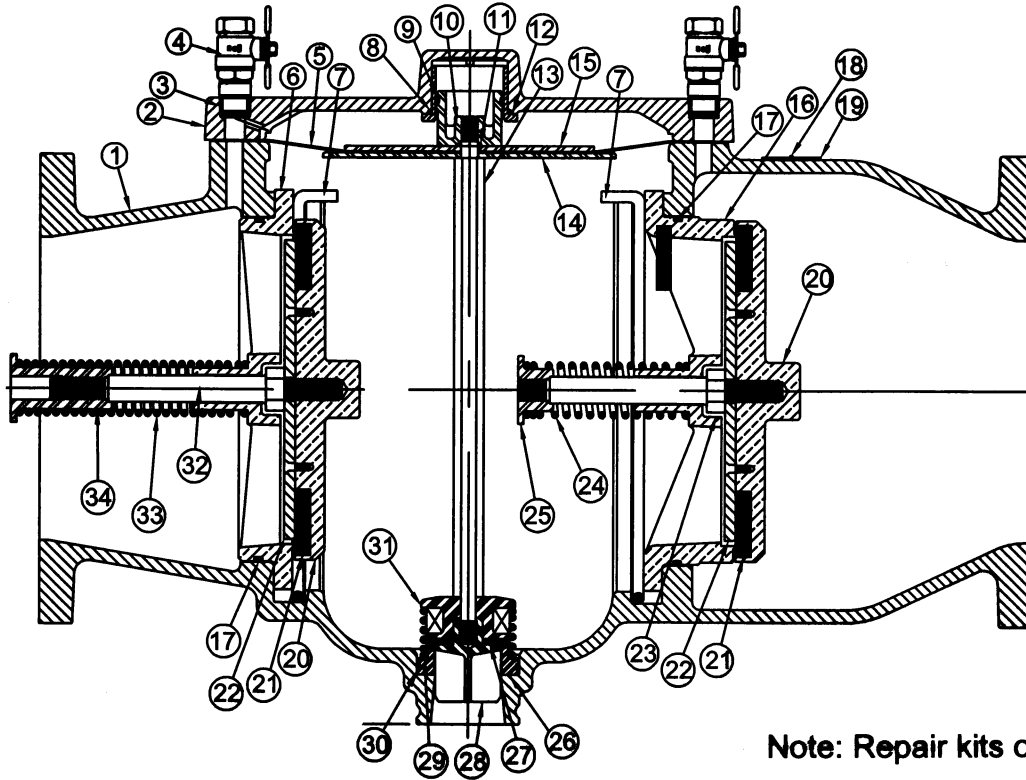

Note: Repair kits on page FM6

Item #	Qty	Description	Material	ASTM	Item #	Qty	Description	Material	ASTM
1	1	Body	Ductile Iron*	60-40-18	21	2	CV Disc	Silicone Rubber	----
2	1	Cover	Ductile Iron*	60-40-18	22	2	CV Disc Retainer	Stainless Steel	304
3	4	Nipple	Red Brass	----	23	1	2nd CV Stem	Stainless Steel	304
4	4	Ball Valve	Unleaded Bronze	C90500	24	1	2nd CV Spring	Stainless Steel	302
5	1	Diaphragm	Nitrile/Nylon	----	25	1	2nd CV Stem Retainer	Stainless Steel	304
6	1	1st CV Seat Ring	Unleaded Bronze	C89833	26	1	RV Seat	Stainless Steel	304
7	2	CV Spring Clip	Stainless Steel	302	27	1	RV Disc	Silicone Rubber	----
8	1	RV Bushing O'Ring	Buna-n	----	28	1	RV Disc Retainer	Noryl GFN2-780S	----
9	1	RV Piston O'Ring	Silicone Rubber	----	29	1	RV Spring	Stainless Steel	302
10	1	RV Piston	Noryl GFN2-780S	----	30	1	RV Seat O'Ring	Buna-n	----
11	1	RV Stem O'Ring	Buna-n	----	31	1	RV Disc Holder	Noryl GFN2-780S	----
12	1	RV Cover Bushing	Unleaded Bronze	C89833	32	1	1st CV Stem	Stainless Steel	304
13	1	RV Stem	Stainless Steel	304	33	1	1st CV Spring	Stainless Steel	302
14	1	RV Diaphragm Plate (LOWER)	Stainless Steel	304	34	1	1st CV Stem Retainer	Stainless Steel	304
15	1	RV Diaphragm Plate (UPPER)	Stainless Steel	304	35	2	R.W. NRS Gate Valve	Cast Iron*	----
16	1	2nd CV Seat Ring	Unleaded Bronze	C89833	36	2	Ring Gasket	Buna-n	----
17	2	CV Seat O'Ring	Buna-n	----	37	16	Bolt	Stainless Steel	18-8
18	2	Grip Nail	Stainless Steel	304	38	24	Bolt	Galvanized Steel	----
19	1	ID Tag	Brass	----	39	24	Nut	Galvanized Steel	----
20	2	CV Disc Holder	Unleaded Bronze	C89833	40	12	Screw	Stainless Steel	18-8

CV = Check Valve * = Items are Epoxy Coated
RV = Relief Valve Items 35-40 are not shown on drawing

Models:

RPZ / RPZ II
RPZE / RPZE II

Size	Relief Complete	1st Check	2nd Check	Rubber Kit
1/2" & 3/4" RPZII / RPZEII	89880P9 (4, 5, 6, 7, 8, 9, 20, 21, 22)	89878P9 (10, 11, 12, 13, 14, 15, 16, 17)	89879P9 (10, 12, 14, 15, 16, 17, 18, 19)	B93RK99 (5, 6, 8, 12, 15, 22)
3/4" & 1"	89850P0 (4, 5, 6, 7, 8, 9, 20, 21, 22)	89848P0 (10, 11, 12, 13, 14, 15, 16, 17)	89849P0 (10, 12, 14, 15, 16, 17, 18, 19)	B92RK00 (5, 6, 8, 12, 15, 22)
1 1/2" & 2"	89850P3 (4, 5, 6, 7, 8, 9, 20, 21, 22)	89848P3 (10, 11, 12, 13, 14, 15, 16, 17)	89849P3 (10, 12, 14, 15, 16, 17, 18, 19)	B92RK03 (5, 6, 8, 12, 15, 22)
1 1/2" RPZII / RPZEII	89880P3 (4,5,6,7,8,9,20,21,22)	89878P3 (10,11,12,13,14,15,16,17)	89879P3 (10,12,14,15,16,17,18,19)	B93RK03 (5,6,8,12,15,22)
2 1/2" & 3"	89850P5 (4, 5, 6, 7, 8, 9, 20, 21, 22)	89848P5 (10, 11, 12, 13, 14, 15, 16, 17)	89849P5 (10, 12, 14, 15, 16, 17, 18, 19)	B92RK05 (5, 6, 8, 12, 15, 22)
4"	89850P7 (4, 5, 6, 7, 8, 9, 20, 21, 22)	89848P7 (10, 11, 12, 13, 14, 15, 16, 17)	89879P7 (10, 12, 14, 15, 16, 17, 18, 19)	B92RK07 (5, 6, 8, 12, 15, 22)
6"	89850P9 (4, 5, 6, 7, 8, 9, 20, 21, 22)	89848P9 (10, 11, 12, 13, 14, 15, 16, 17)	89849P9 (10, 12, 14, 15, 16, 17, 18, 19)	B92RK09 (5, 6, 8, 12, 15, 22)
8"	89850P10 (4, 5, 6, 7, 8, 9, 20, 21, 22)	89848P10 (10, 11, 12, 13, 14, 15, 16, 17)	89879P10 (10, 12, 14, 15, 16, 17, 18, 19)	B92RK10 (5, 6, 8, 12, 15, 22)