

**MODELS 350DA, 350ADA
450DA, 375DA, 375ADA
475DA, 475DAV**



**Double Check/ Reduced Pressure Principle
Detector Assemblies 2-1/2" to 10"**

REPAIR KITS

CHECKS ONLY		COMPLETE KIT (RUBBER ONLY)		
RK212-350ADA REPAIR KIT 350ADA MODELS, 2-1/2" & 3" RUBBER Only		RK212-375ADAC REPAIR KIT 375ADA MODELS, 2-1/2" & 3" Checks & Relief Valves		
RT NO.	DESCRIPTION	PART NO.	QTY.	DESCRIPTION
RK34-950XLR	REPAIR KIT for MODEL 950/975, 3/4"	RK34-975XLR	1	REPAIR KIT for MODEL 950/975, 3/4"
RK4-350	REPAIR KIT for MODEL 350A/375A, 2-1/2" & 3"	RK4-350	1	REPAIR KIT for MODEL 350A/375A, 2-1/2" & 3"
		RK212-375R	1	REPAIR KIT for MODEL 375 REL. VALVE 2-1/2" & 3"
RK212-350DA REPAIR KIT 350DA, 450DA, 2-1/2" & 3" RUBBER Only		RK212-375DAC REPAIR KIT 375DA, 475DA Models, 2-1/2" & 3" Checks & Relief Valves		
RT NO.	DESCRIPTION	PART NO.	QTY.	DESCRIPTION
RK34-950XLR	REPAIR KIT for MODEL 950/975, 3/4"	RK34-975XLR	1	REPAIR KIT for MODEL 950/975, 3/4"
RK212-350	REPAIR KIT for MODEL 350/375, 2-1/2" & 3"	RK212-350	1	REPAIR KIT for MODEL 350/375, 2-1/2" & 3"
		RK212-375R	1	REPAIR KIT for MODEL 375 REL. VALVE 2-1/2" & 3"
RK4-350DA REPAIR KIT ALL DA MODELS, 4" RUBBER Only		RK4-375DAC REPAIR KIT ALL RPDA Models, 4" Checks & Relief Valves		
PART NO.	DESCRIPTION	PART NO.	QTY.	DESCRIPTION
RK34-950XLR	REPAIR KIT for MODEL 950/975, 3/4"	RK34-975XLR	1	REPAIR KIT for MODEL 975, 3/4"
RK4-350	REPAIR KIT for MODEL 350(A)/375(A), 4"	RK4-350	1	REPAIR KIT for MODEL 350(A)/375(A), 4"
		RK212-375R	1	REPAIR KIT for MODEL 375(A) Relief Valve, 4"
RK6-350DA REPAIR KIT ALL DA MODELS, 6" RUBBER Only		RK4-375DAC REPAIR KIT ALL RPDA Models, 6" Checks & Relief Valves		
RT NO.	DESCRIPTION	PART NO.	QTY.	DESCRIPTION
RK34-950XLR	REPAIR KIT for MODEL 950/975, 3/4"	RK34-975XLR	1	REPAIR KIT for MODEL 975, 3/4"
RK6-350	REPAIR KIT for MODEL 350(A)/375(A), 6"	RK6-350	1	REPAIR KIT for MODEL 350(A)/375(A), 6"
		RK212-375R	1	REPAIR KIT for MODEL 375(A) Relief Valve, 6"
RK8-350DA REPAIR KIT ALL DA MODELS, 8" & 12" RUBBER Only		RK8-375DAC REPAIR KIT ALL RPDA Models, 8" & 10" Checks & Relief Valves		
RT NO.	DESCRIPTION	PART NO.	QTY.	DESCRIPTION
RK34-950XLR	REPAIR KIT for MODEL 950/975, 3/4"	RK34-975XLR	1	REPAIR KIT for MODEL 975, 3/4"
RK8-350	REPAIR KIT for MODEL 350(A)/375(A), 8" & 10"	RK8-350	1	REPAIR KIT for MODEL 350(A)/375(A), 8" & 10"
		RK8-375R	1	REPAIR KIT for MODEL 375(A) Relief Valve, 8" & 10"

#2 CHECK ASSEMBLIES FOR 350DA, 450DA, 375DA, 475DA, 475DAV

ZE	MODEL	#2 CHECK ASSY	MODEL	#2 CHECK ASSY
2 1/2" & 3"	350ADA/375ADA	3509-300B		
2 1/2" & 3"	350DA/375DA	3507DA-300	350ADA/375ADA	3504-300B
4"	350DA(A)/375DA(A)	3509-300B	450DA/475DA/475DAV	3509-300B
6"	350DA(A)/375DA(A)	3510-300B	450DA/475DA/475DAV	3510-300B
8"	350DA, 350ADA	3512DA-300	450DA/475DA/475DAV	4512DA-300
10"	350DA		350ADA, 375DA(A)	
12"	350DA (#1 CHECK)	3513DA-300A	350DA	3513DA-300B

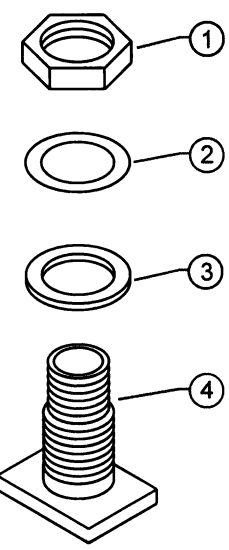

BULKHEAD FITTINGS

	DESCRIPTION	BHF1B-100	BHF1C-100	BHF2B-100	BHF2C-100
1	NUT	BHF1-9-010F	BHF1-9-010F	BHF2-9-010F	BHF2-9-010F
2	WASHER	BHF1-14	BHF1-14	BHF2-14	BHF2-14
3	GASKET	BHF1-13	BHF1-13	BHF1-13	BHF1-13
4	FITTING	BHF1-19B-010F	BHF1-19C-010F	BHF2-19B-010F	BHF2-19C-010F