

# MODEL 975XL

## Reduced Pressure Principle Backflow Preventers 3/4" to 2"

# WILKINS

A **ZURN**™ Company

| ITEM NO. | DESCRIPTION                     | 3/4"        | 1"         | 1-1/4"     | 1-1/2"     | 2"         |
|----------|---------------------------------|-------------|------------|------------|------------|------------|
| 1        | BALL VALVE, TAPPED              | 34-850T     | 1-850T     | 114-850T   | 112-850T   | 2-850T     |
| 2        | BALL VALVE                      | 34-850      | 1-850      | 114-850    | 112-850    | 2-850      |
| 3        | O-RING, CHECK SEAT              | 125N        | 125N       | 142N       | 142N       | 142N       |
| 4        | CHECK SEAT                      | 952-18S     | 952-18S    | 954-18S    | 954-18S    | 954-18S    |
| 5        | RETAINING BOLT                  | 952-11      | 952-11     | 952-11     | 952-11     | 952-11     |
| 6        | SEAL RING RETAINER              | 952-14      | 952-14     | 954-14     | 954-14     | 954-14     |
| 7        | SEAL RING                       | 952-12S     | 952-12S    | 954-12S    | 954-12S    | 954-12S    |
| 8        | POPPET                          | 952-30      | 952-30     | 954-30     | 954-30     | 954-30     |
| 9        | NO. 1 CHECK SPRING              | 972-33      | 972-33     | 5754-33    | 5754-33    | 5754-33    |
| 10       | O-RING, COVER                   | 136N        | 136N       | 153N       | 153N       | 153N       |
| 11       | CHECK COVER                     | 952-3-010F  | 952-3-010F | 954-3-010F | 954-3-010F | 954-3-010F |
| 12       | POPPEY ASSY.                    | 952-300S    | 952-300S   | 954-300S   | 954-300S   | 954-300S   |
| 13       | NO. 2 CHECK SPRING              | 952-33      | 952-33     | 554-33     | 554-33     | 554-33     |
| 14       | TEST COCK                       | 18-860      | 18-860     | 14-860     | 14-860     | 14-860     |
| 15       | O-RING, RELIEF VALVE SEAT       | 019N        | 019N       | 029N       | 029N       | 029N       |
| 16       | RELIEF VALVE SEAT               | 972-18      | 972-18     | 974-18     | 974-18     | 974-18     |
| 17       | RELIEF VALVE SPRING             | 972A-33     | 972A-33    | 974A-33    | 974A-33    | 974A-33    |
| 18       | RELIEF VALVE RETAINING BOLT     | 972-11A     | 972-11A    | 604B-11    | 604B-11    | 604B-11    |
| 19       | RELIEF VALVE SEAL RING RETAINER | 972-14      | 972-14     | 552-14     | 552-14     | 552-14     |
| 20       | RELIEF VALVE SEAL RING          | 972-12S     | 972-12S    | 974-12S    | 974-12S    | 974-12S    |
| 21       | RELIEF VALVE LOWER PLUNGER      | 972-34A     | 972-34A    | 974-34A    | 974-34A    | 974-34A    |
| 22       | RELIEF VALVE DIAPHRAGM          | 972-43      | 972-43     | 974-43     | 974-43     | 974-43     |
| 23       | RELIEF VALVE UPPER PLUNGER      | 972-34      | 972-34     | 974-34     | 974-34     | 974-34     |
| 24       | O-RING, RELIEF VALVE STEM       | 111N        | 111N       | 121N       | 121N       | 121N       |
| 25       | RELIEF VALVE STEM ASSY.         | 972-50S     | 972-50S    | 974-50S    | 974-50S    | 974-50S    |
| 26       | RELIEF VALVE COVER BOLT         | 554-11A     | 554-11A    | 554-11A    | 554-11A    | 554-11A    |
| 27       | R.V. & CHECK SEAT TOOL KIT      | RK-975 TOOL |            |            |            |            |

### REPAIR KITS

| NO. RK34-975XL  |      |                           | REPAIR KIT COMPLETE<br>Model 975XL 3/4" & 1" Only |      |                           | NO. RK114-975XL  |      |             | REPAIR KIT COMPLETE<br>Model 975XL 1-1/4", 1-1/2", 2" Only |      |             |
|-----------------|------|---------------------------|---|------|---------------------------|------------------|------|-------------|--|------|-------------|
| PART NO.        | QTY. | DESCRIPTION               | PART NO.  | QTY. | DESCRIPTION               | PART NO.         | QTY. | DESCRIPTION | PART NO.   | QTY. | DESCRIPTION |
| 952-12S         | 2    | SEAL RING                 | 954-12S   | 2    | SEAL RING                 |                  |      |             |  |      |             |
| 972-12S         | 1    | RELIEF VALVE SEAL RING    | 974-12S   | 1    | RELIEF VALVE SEAL RING    |                  |      |             |  |      |             |
| 972-43          | 1    | DIAPHRAGM                 | 974-43  | 1    | DIAPHRAGM                 |                  |      |             |  |      |             |
| 136N            | 2    | O-RING, COVER             | 153N  | 2    | O-RING, COVER             |                  |      |             |  |      |             |
| 111N            | 1    | O-RING, RELIEF VALVE STEM | 121N  | 1    | O-RING, RELIEF VALVE STEM |                  |      |             |  |      |             |
| 972-33          | 1    | NO. 1. CHECK SPRING       | 5754-33   | 1    | NO. 1. CHECK SPRING       |                  |      |             |  |      |             |
| 952-33          | 1    | NO. 2 CHECK SPRING        | 554-33  | 1    | NO. 2 CHECK SPRING        |                  |      |             |  |      |             |
| 972A-33         | 1    | RELIEF VALVE SPRING       | 974A-33   | 1    | RELIEF VALVE SPRING       |                  |      |             |  |      |             |
| NO. RK34-975XLR |      |                           | RUBBER REPAIR KIT<br>Model 975XL 3/4" & 1" Only   |      |                           | NO. RK114-975XLR |      |             | RUBBER REPAIR KIT<br>Model 975XL 1-1/4", 1-1/2", 2" Only   |      |             |
| PART NO.        | QTY. | DESCRIPTION               | PART NO.  | QTY. | DESCRIPTION               | PART NO.         | QTY. | DESCRIPTION | PART NO.   | QTY. | DESCRIPTION |
| 952-12S         | 2    | SEAL RING                 | 954-12S   | 2    | SEAL RING                 |                  |      |             |  |      |             |
| 972-12S         | 1    | RELIEF VALVE SEAL RING    | 974-12S   | 1    | RELIEF VALVE SEAL RING    |                  |      |             |  |      |             |
| 972-43          | 1    | DIAPHRAGM                 | 974-43  | 1    | DIAPHRAGM                 |                  |      |             |  |      |             |
| 136N            | 2    | O-RING, COVER             | 153N  | 2    | O-RING, COVER             |                  |      |             |  |      |             |
| 111N            | 1    | O-RING, RELIEF VALVE STEM | 121N  | 1    | O-RING, RELIEF VALVE STEM |                  |      |             |  |      |             |

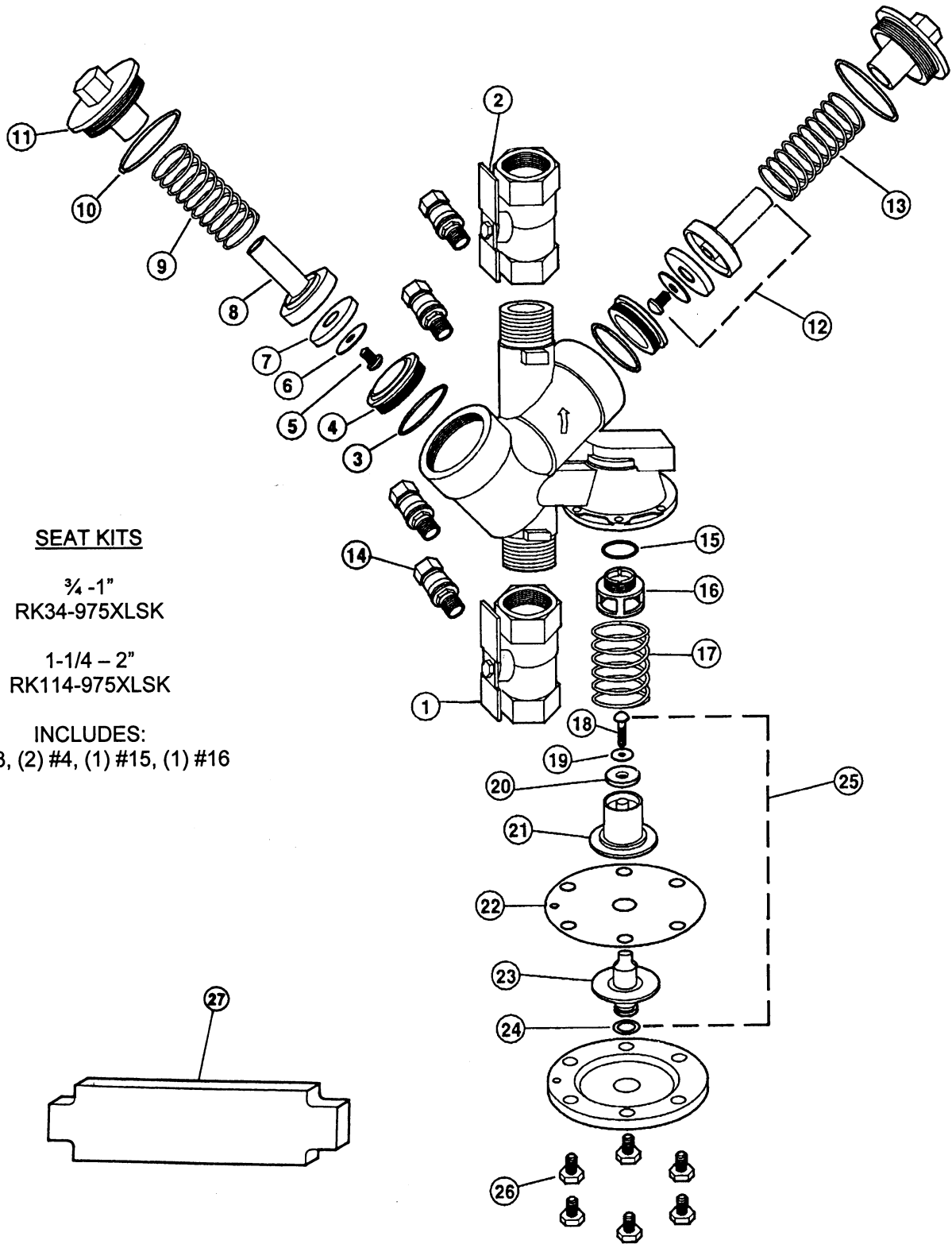

**SEAT KITS**

3/4 - 1"  
RK34-975XLSK

1-1/4 - 2"  
RK114-975XLSK

INCLUDES:  
(2) #3, (2) #4, (1) #15, (1) #16