

# SUBMITTAL DATA SHEET

125LB Threaded Brass Pipe Fittings  
90° Brass Elbow - 2290

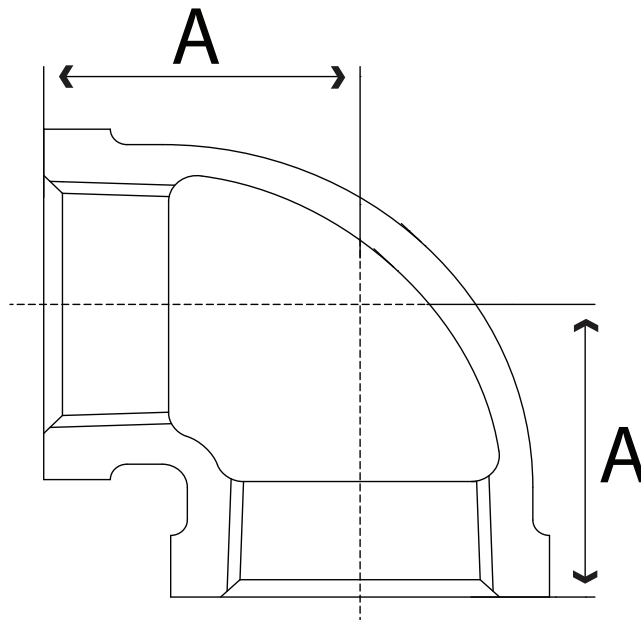

A.Y. McDonald Mfg. Co. Pipe Fittings & Nipples are constructed from heavy duty brass and are rated for commercial, industrial and residential applications up to 125 WOG. Threads conform to ANSI B1.20.1 and fitting dimensions comply with ANSI B16.15.



## Dimensions

Model Number	Size	A	Ctn Qty	Wt.
2290	1/4"	0.71"	5	0.11
2290	1/2"	1.02"	5	0.25
2290	3/4"	1.18"	5	0.35
2290	1"	1.42"	5	0.62
2290	1 1/4"	1.69"	5	0.97
2290	1 1/2"	1.85"	5	1.29
2290	2"	2.13"	5	2.02

## SUBMITTAL INFORMATION

- **Materials**  
C89833, AWWA C800, ASTM B584
- **Fitting Dimensions**  
ANSI B 16.15, Class 125

- **Union Dimensions**  
WWW-U-516-B
- **Threads**  
ANSI / ASME B1.20.1



Non-Potable  
Use Only



A.Y. McDonald Mfg. Co.  
P.O. Box 508  
Dubuque, IA 52004-0508

Toll Free: 1-800-292-2737  
Fax: 1-800-832-9296  
Hours: 7:00 a.m. - 5:00 p.m., CST

sales@aymcdonald.com  
www.aymcdonald.com

A.Y. McDonald considers the information on this assembly drawing correct when published. Item and option availability, including specifications, are subject to change without notice.

Submitted by:

# SUBMITTAL DATA SHEET

125LB Threaded Brass Pipe Fittings  
90° Brass Reducing Elbow - 2290



A.Y. McDonald Mfg. Co. Pipe Fittings & Nipples are constructed from heavy duty brass and are rated for commercial, industrial and residential applications up to 125 WOG. Threads conform to ANSI B1.20.1 and fitting dimensions comply with ANSI B16.15.

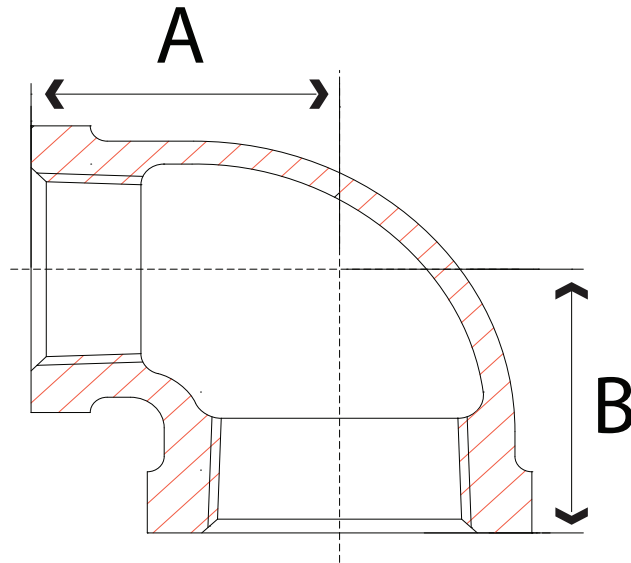

## Dimensions

Model Number	Size	A	B	Ctn Qty	Wt.
2290	3/4" x 1/2"	1.10"	1.06"	5	0.32
2290	1" x 3/4"	1.31"	1.30"	5	0.54

## SUBMITTAL INFORMATION

- **Materials**  
C89833, AWWA C800, ASTM B584
- **Fitting Dimensions**  
ANSI B 16.15, Class 125
- **Union Dimensions**  
WWW-U-516-B
- **Threads**  
ANSI / ASME B1.20.1



Non-Potable  
Use Only



A.Y. McDonald Mfg. Co.  
P.O. Box 508  
Dubuque, IA 52004-0508

Toll Free: 1-800-292-2737  
Fax: 1-800-832-9296  
Hours: 7:00 a.m. - 5:00 p.m., CST

sales@aymcdonald.com  
www.aymcdonald.com

A.Y. McDonald considers the information on this assembly drawing correct when published. Item and option availability, including specifications, are subject to change without notice.

Submitted by: